

- BA270104 - LIVE WALL LOFTY x 04
- BA270106 - LIVE WALL LOFTY x 06
- BA270108 - LIVE WALL LOFTY x 08
- BA270112 - LIVE WALL LOFTY x 12

CASE STANDARD SPEC:

- INTERNAL CASE COLOUR
- BLACK KICK PLATE
- 4/5 x UNLIT STAINLESS STEEL SHELVES
- T8/T5 CANOPY FLUORESCENT LIGHTS
- FRONT FENCES
- FLAT BOTTOM PAN & FRONT FENCE
- THERMOSTATIC EXPANSION VALVE (BRASS)
- 2 x PROBES (AIR OFF & DEFROST)
- SHADED POLE FAN MOTOR (SPM)
- STANDARD COIL
- ALUMINIUM TICKET RAIL OR PLASTIC TICKET RAIL
- ELECTRONIC DISPLAY
- BULLNOSE SHELF

CASE OPTIONAL SPEC:

- 40mm LOFTY FULL PATCH-END
- 40mm LOFTY PATCH-END WITH GLASS
- CLADDING OPTIONS: REFER TO CLAD DETAILS DOCUMENT (AVAILABLE ON DEMAND)
- ECM FANS
- ELECTRONIC VALVE (EV)
- BULLNOSE STAINLESS STEEL SHELVES
- LED CANOPY LIGHTS: FRT5 NW HIGH CRI
- LED SHELF LIGHTS: FRT5 NW 4000K-24V

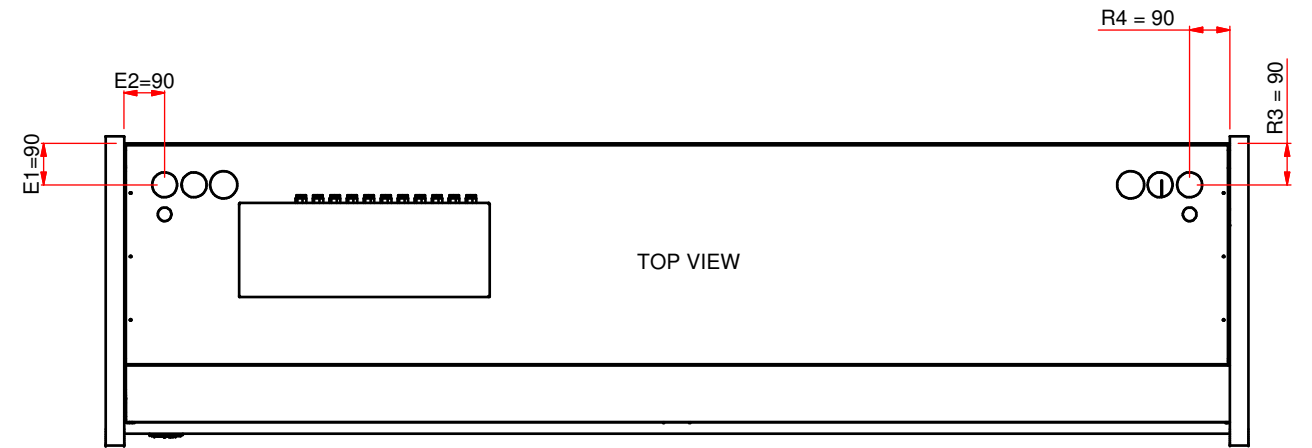
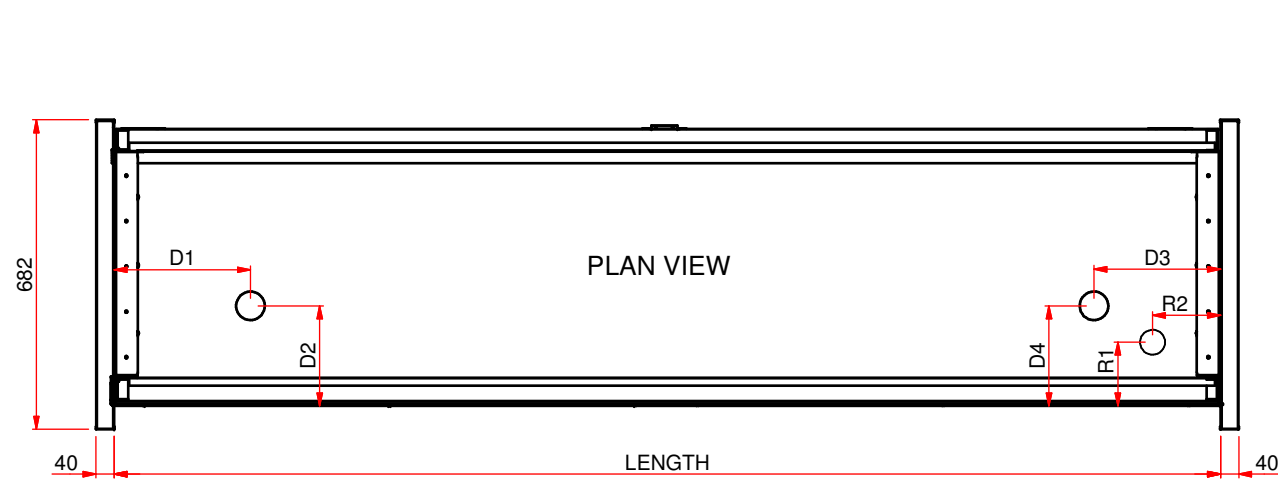
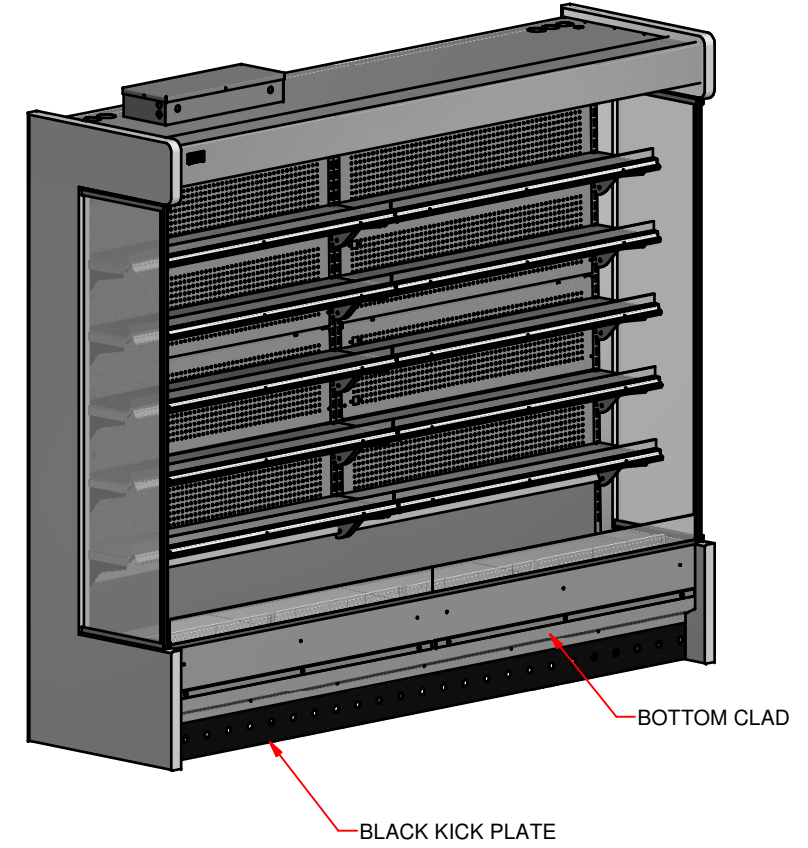
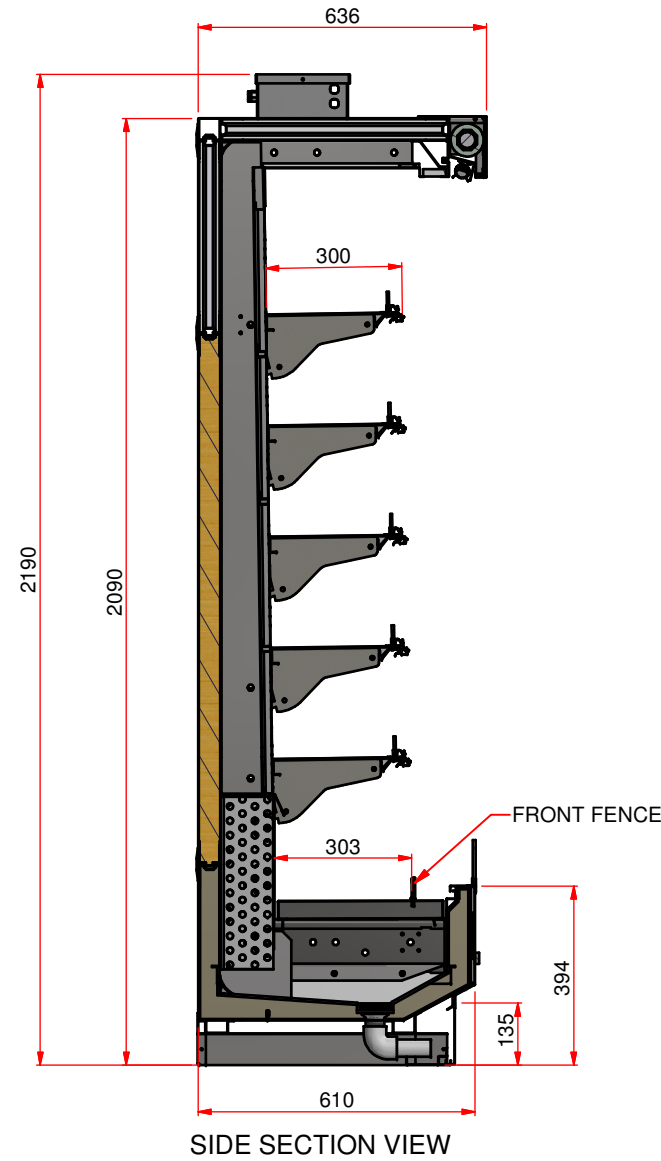

NOTE
COLOURS USED FOR REPRESENTATION PURPOSE ONLY

| Refrigeration Requirements | |
|----------------------------|------------------|
| REFRIGERATION | EVAPORATION TEMP |
| 480 W/ft | -8°C |

| Physical Properties | | | Drain Points and Refrigeration Points | | | | | | Electrical Specifications | | | | |
|---------------------|------------|----------|---------------------------------------|--------|--------|--------|---------------|---------------|--------------------------------------|-----------------------------------|--------------------|-----------------------------|------------------------------|
| Size | Length (m) | TDA (m²) | D1 | D2 | D3 | D4 | R1 (Btm exit) | R2 (Btm exit) | Evaporator Fans Fan Blade + Motor | Heaters Anti-Sweat (Glass End) | Heaters Defrost | Lighting Case (T5 Tubes) | Lighting Shelf (T8 Tubes) |
| 4FT | 1.22 | 1.82 | - | - | 210 mm | 300 mm | 140 mm | 150 mm | 2 x Φ230-31"/60W (ECM) or 24W (ECM) | 1 x 16 W/m x 3.5 m | 1 x 800W | 1 x 4FT = 54W | 5 x 3FT = 150W |
| 6FT | 1.83 | 2.74 | - | - | 210 mm | 300 mm | 140 mm | 150 mm | 4 x Φ230-31"/60W (ECM) or 24W (ECM) | 1 x 16 W/m x 3.5 m | 1 x 1200W | 2 x 3FT = 78W | 5 x 5FT = 290W |
| 8FT | 2.44 | 3.66 | 210 mm | 300 mm | 210 mm | 300 mm | 140 mm | 150 mm | 5 x Φ230-31"/60W (ECM) or 24W (ECM) | 1 x 16 W/m x 3.5 m | 1 x 1600W | 2 x 4FT = 108W | 10 x 3FT = 300W |
| 12FT | 3.66 | 5.48 | 210 mm | 300 mm | 210 mm | 300 mm | 140 mm | 100 mm | 6 x Φ230-31"/60W (ECM) or 24W (ECM) | 1 x 16 W/m x 3.5 m | 1 x 2400W | 3 x 4FT = 162W | 15 x 3FT = 450W |

| | | | |
|--|------------------------|------------------------------------|------------------------------------|
| COLCAB CAPE TOWN Butskop Road, Blackheath Tel: +27 (21) 907-2800 Fax: +27 (21) 907-2850 info.cpt@colcabct.co.za | Case Range | Case Description | |
| | B2701 | LIVE WALL LOFTY | |
| | PAGE 1 OF 2 | Released by G.B. | Released date 2018/01/18 |
| | Revision R00 | Revision date 2018/01/18 | |
| INTELLECTUAL PROPERTY OF COLCAB (PTY) LTD INFORMATION SHOWN SUBJECT TO CHANGE WITHOUT PRIOR NOTICE | | | |



| | | | |
|--|------------------------|------------------------------------|------------------------------------|
|  COLCAB <small>REFRIGERATION & FREEZING SOLUTIONS</small> CAPE TOWN Butskop Road Blackheath Tel: +27 (21) 907-2800 Fax: +27 (21) 907-2850 info.cpt@colcabct.co.za | Case Range | Case Description | |
| | B2701 | LIVE WALL LOFTY | |
| | PAGE 2 OF 2 | Released by G.B | Released date 2018/01/18 |
| | Revision R00 | Revision date 2018/01/18 | |
| <small>INTELLECTUAL PROPERTY OF COLCAB (PTY) LTD INFORMATION SHOWN SUBJECT TO CHANGE WITHOUT PRIOR NOTICE</small> | | | |